

# PVC/CPVC Union Type 375

## Features, Advantages, Benefits

- Specifically designed for 375 valves
- Interchangeable ends
- New, sleeker design
- Reliable construction
- 235 psi @ 73°F (10.3 bar @ 22.7°C)
- GF quality



## General

GF Piping Systems introduces the Schedule 80 Union Type 375 fittings. Available size options range from 1/2" to 2" in both PVC and CPVC material, all with a pressure rating up to 235 psi at 73°F. Type 375 Unions are available with socket by socket or threaded by threaded ends.

The 375 Unions are specifically engineered to connect with the Type 375 True Union Ball Valves. The unions and ball valves are ideally suited for basic applications encompassing the water processing/treatment sector, as well as other applications involving water.

## Dimensions

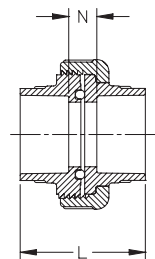

Socket x Socket

Size [inch]	L [inch]	N [inch]
1/2	2.16	0.41
3/4	2.44	0.43
1	2.66	0.53
1 1/4	2.98	0.50
1 1/2	3.28	0.56
2	3.53	0.57

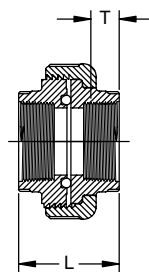

FTP x FTP

Size [inch]	L [inch]	T [inch]
1/2	2.03	0.53
3/4	2.11	0.55
1	2.56	0.68
1 1/4	2.79	0.71
1 1/2	2.72	0.72
2	2.89	0.76

The technical data is not binding. They neither constitute expressly warranted characteristics nor guaranteed properties nor guaranteed durability. They are subject to modification. Our General Terms of Sale apply.



### PVC/CPVC Union Type 375 (S × S)



Size [inch]	PVC EPDM Part No.	PVC FPM Part No.	CPVC EPDM Part No.	CPVC FPM Part No.	Pack Qty
1/2	897-375-005	857-375-005	9897-375-005	9857-375-005	25
3/4	897-375-007	857-375-007	9897-375-007	9857-375-007	10
1	897-375-010	857-375-012	9897-375-010	9857-375-010	5
1 1/4	897-375-012	857-375-012	9897-375-012	9857-375-012	5
1 1/2	897-375-015	857-375-015	9897-375-015	9857-375-015	5
2	897-375-020	857-375-020	9897-375-020	9857-375-020	2

### PVC/CPVC Union Type 375 (FPT × FPT)



Size [inch]	PVC EPDM Part No.	PVC FPM Part No.	CPVC EPDM Part No.	CPVC FPM Part No.	Pack Qty
1/2	898-375-005	858-375-005	9898-375-005	9858-375-005	25
3/4	898-375-007	858-375-007	9898-375-007	9858-375-007	10
1	898-375-010	858-375-010	9898-375-010	9858-375-010	5
1 1/4	898-375-012	858-375-012	9898-375-012	9858-375-012	5
1 1/2	898-375-015	858-375-015	9898-375-015	9858-375-015	5
2	898-375-020	858-375-020	9898-375-020	9858-375-020	2

Current list prices available at [www.gfpiping.com](http://www.gfpiping.com). Sold in box quantities only.

\*Standard style unions in sizes 1/2" through 2" available in limited quantities until December 2013.

Also available:

### Metal Union End Connectors Type 375 (316 SS)



Size [inch]	Part No.	Pack Qty
1/2	1694-375-005	1
3/4	1694-375-007	1
1	1694-375-010	1
1 1/4	1694-375-012	1
1 1/2	1694-375-015	1
2	1694-375-020	1

## GF Piping Systems

2882 Dow Avenue, Tustin, CA 92780-7258

Tel. (714) 731-8800, Toll Free (800) 854-4090, Fax (714) 731-6201

e-mail: [us.ps@georgfischer.com](mailto:us.ps@georgfischer.com)

[www.gfpiping.com](http://www.gfpiping.com)